

HOW TO ORDER

Series No. **No. of Pins** **Contact Type** **Pin Type** **Shell Plating** **Contact Plating** **Housing Color** **Boardlock** **Screwlock**
R30 - **25** - **M** - **S** - **T** - **S** - **W** - **B** - **1**
 09 15 25 **M:Male** **S:Stamped** **T:Tin** **S:Selective** **W:White** **Blank:w/o boardlock** **1:with Screwlock**
 37 50 **F:Female** **M:Machined** **Z:Zinc** **G:Gold Flash** **B:Black** **N1:with front 4-40 nut** **blank:w/o**
N:13mm Machined **N2:with front 4-40 nut** **screwlock**
N3:with rear 4-40 nut
N4:with rear M3 nut
(no boardlock,no screw)

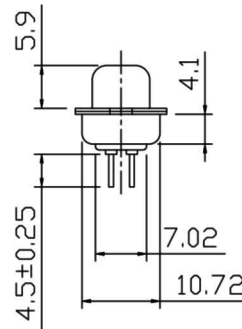
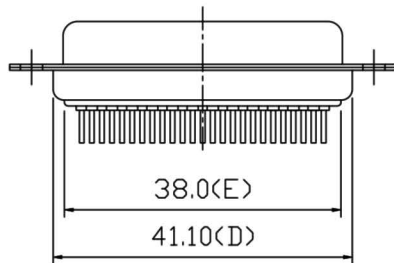
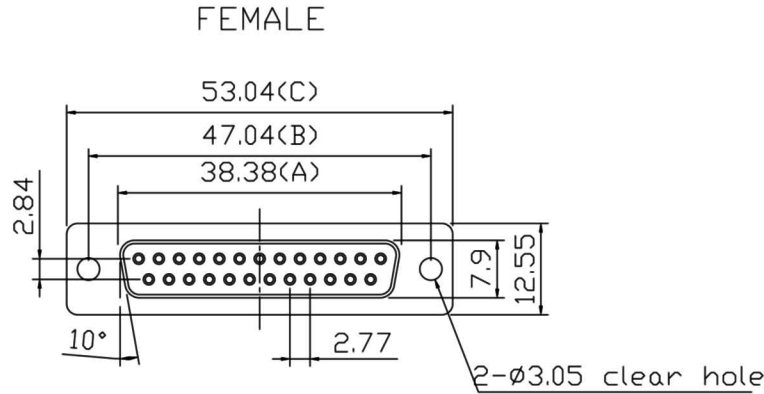

Dimension

Position	A	B	C	D	E
9	16.33	24.99	30.81	19.20	15.45
15	24.99	33.32	39.14	27.70	24.45
25	38.38	47.04	53.04	41.10	38.00
37	54.84	63.50	69.32	57.30	53.96

Specifications

Contact Resistance: 30mΩ max. at DC 100mA
Insulator Resistance: 1000MΩ min. at DC 500V
Current Rating: 5 AMP
Dielectric Withstanding Voltage: AC 1000V For 1 minute
Operating Temperature: -55°C ~ +105°C
Contact: Brass
Housing: PBT & 30% Glass Fiber (UL 94V-0)

				Technical Data Sheet		
REV.	CONTENTS	DATE				
 <small>UNLESS OTHERWISE SPECIFIED TOLERANCE</small> Inch: .000 = ±0.01 .0000 = ±0.0050 mm: .00 = ±0.25 .000 = ±0.130 Ang: 0.0 = ±2°	Drawn	Lisa		Title:		
	Designed	Nelson		D-SUB DIP STRAIGHT TYPE		
	Approval	Vincent		Part No	R30-xx-F-S-x-x-x	
	Rev:	A		Sheet	1	Scale : Size A4
Units	mm		Date:	11-11-2001		