

HOW TO ORDER

Series No. **R30** - No. of Pins **25** - Contact Type **M** - Pin Type **S** - Shell Plating **T** - Contact Plating **S** - Housing Color **W** - Boardlock **B** - Screwlock **1**

09 15 25
37 50

M:Male
F:Female

S:Stamped
M:Machined
N:13mm Machined

T:Tin
Z:Zinc

S:Selective
G:Gold Flash

W:White
B:Black

Blank:w/o boardlock
B: with Boardlock
N1:with front 4-40 nut
nut H=5.6mm
N2:with front 4-40 nut
nut H=4.0mm
N3:with rear 4-40 nut
nut H=4.0mm
N4:with rear M3 nut
nut H=5.8mm
(no boardlock,no screw)

1:with Screwlock
blank:w/o
screwlock

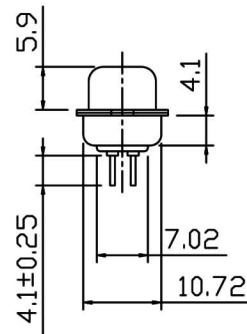
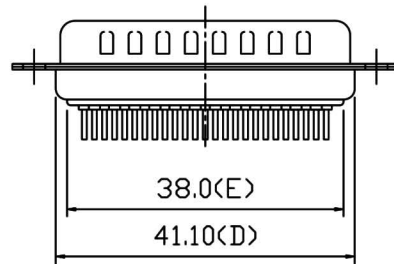
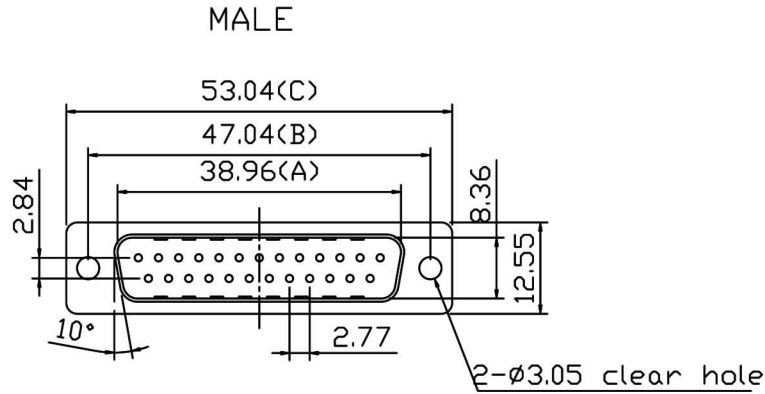

Dimension

Position	A	B	C	D	E
9	16.92	24.99	30.81	19.20	15.45
15	25.50	33.32	39.14	27.70	24.45
25	38.96	47.04	53.04	41.10	38.00
37	55.42	63.50	69.32	57.30	53.96

Specifications
 Contact Resistance: 30mΩ max. at DC 100mA
 Insulator Resistance: 1000MΩ min. at DC 500V
 Current Rating: 5 AMP
 Dielectric Withstanding
 Voltage: AC 1000V For 1 minute
 Operating Temperature: -55°C ~ +105°C
 Contact: Brass
 Housing: PBT & 30% Glass Fiber (UL 94V-0)

REV.		CONTENTS		DATE		Technical Data Sheet	
Drawn Lisa Designed Nelson Approval Vincent		Title: D-SUB DIP STRAIGHT TYPE		Part No R30-xx-M-S-x-x-x		Sheet 1 Scale : Size A4	
UNLESS OTHERWISE SPECIFIED TOLERANCE Inch: .000 = ±0.01 .0000 = ±0.050 mm: .00 = ±0.25 .000 = ±0.130 Ang: 0.0 = ±2°		Rev: A Units mm		Date: 08-11-2001			