

# Stamped & Formed Triple Port D-Sub Connectors



### SPECIFICATIONS

#### Materials

Insulator: PBT, UL94V-0  
 Contacts: Brass, Gold Plated  
 Shell: Steel, Nickel Plated

#### Electrical

Insulation Resistance: 5000MΩ Min  
 Current Rating: 5 Amperes max  
 Dielectric Voltage: 1000V AC for One Minute.  
 Operating Temperature: -55°C ~ 105°C

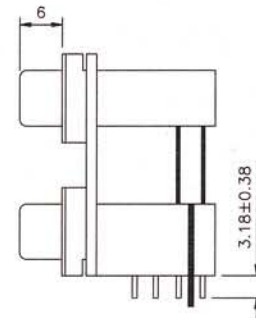
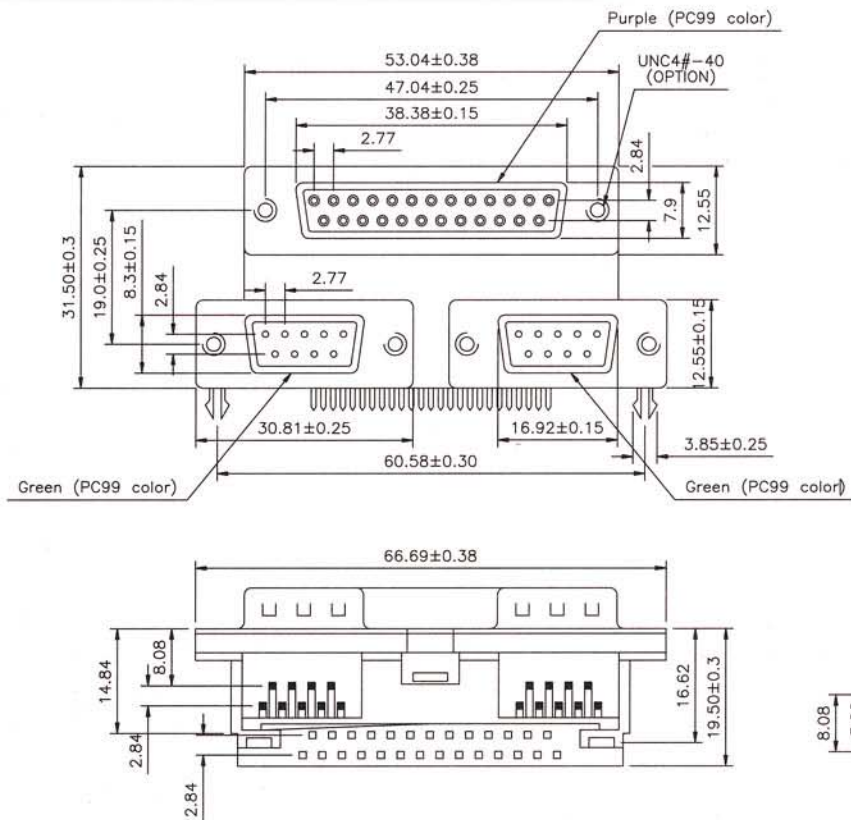

#### RECOMMENDED P.C.B. LAYOUT

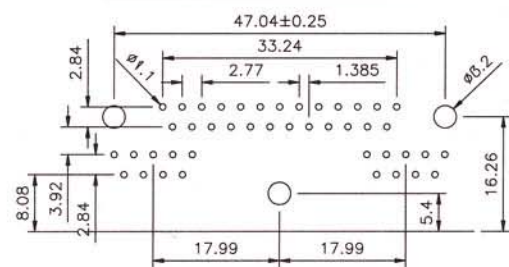

### ORDER INFORMATION

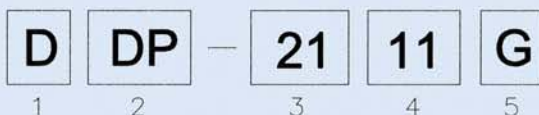

1. Series No.  
D-Sub

3. No.: of Contacts  
21: 25/9/9

5. Contact Plating  
 G: Gold Flash (Standard)  
 A: 5μ" Gold  
 B: 10μ" Gold  
 C: 15μ" Gold  
 D: 30μ" Gold

2. Terminal Version  
DP: Dual-Port

4. Connector Type  
11: Female/Male/Male